

## Step 1

Stand the WaterRower upright and disconnect the bungee from the recoil belt.

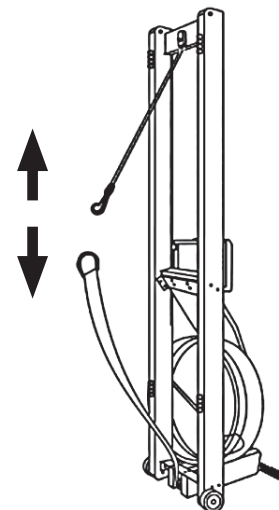

### Tools required:

- 2 x 5 mm Allen Keys (Hex / Inbus)
- 1 x 3 mm Allen Key
- 1 x Adjustable-spanner / wrench

## Step 2

Lay the WaterRower down. Slowly pull the handle and let the drive strap unwind from the clutch housing. Do this gently, as pulling too fast may cause the recoil belt to wind up too much. Disconnect the drive strap from the clutch using the 3 mm Allen key. Pull the strap free of the clutch and remove the strap from the rower completely.

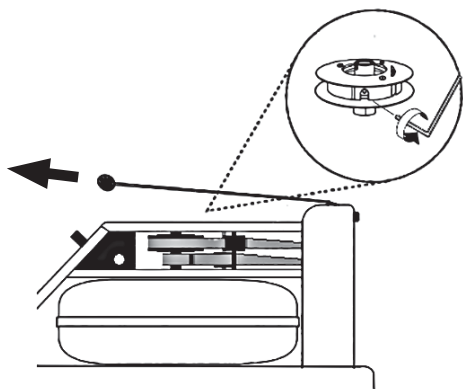

## Step 4

Take the forward riser out of the WaterRower and remove the bottom bracket using an adjustable spanner / wrench. Lift one of the wooden sides and remove the large pulley along with the metal guide. Re-assemble the forward riser (with the two small pulleys only) and mount the metal bracket in the correct position. Mind the position of the hole. (This is a good point to remove your old monitor, might you want to do so.)

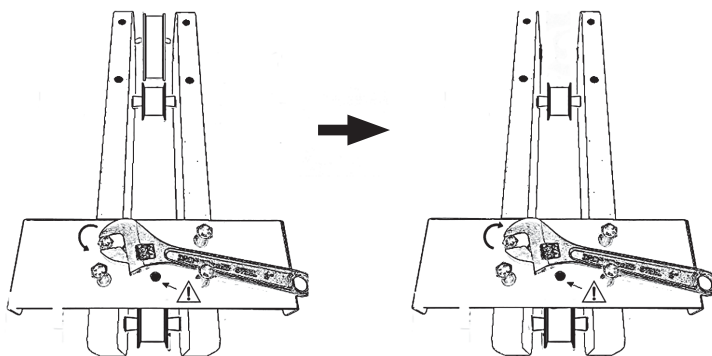

## Step 3

Remove the tie-rods (4x) using a 5 mm Allen key. Remove the fasteners (4x) connecting the forward riser bottom bracket to the side rails, using the two 5 mm Allen keys.

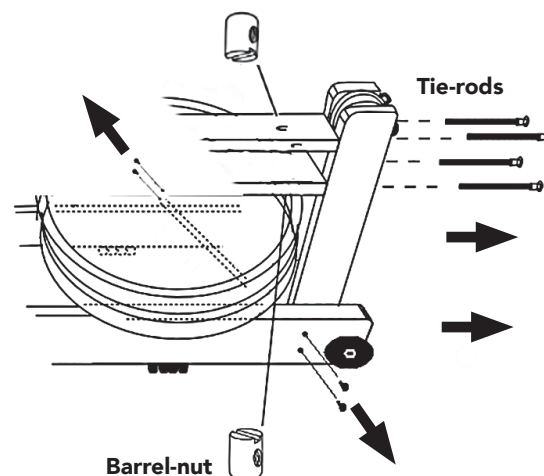

## Step 5

Reconnect the forward riser to the WaterRower with the lower tie-rods (2x). Reassemble the fasteners (4x) connecting the forward riser bottom bracket to the side rails. Align the barrel nuts with the tie-rods and do not tighten these too firmly yet.

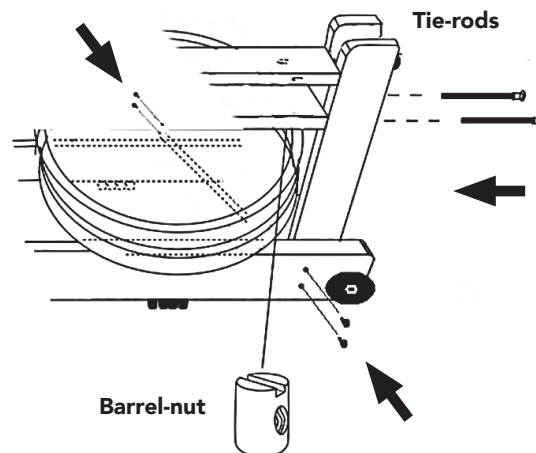

## Step 6

Take the SmartRow assembly and slide it in place as indicated in the picture. Make sure the smaller plastic part encloses the wooden top deck (as seen in the circle). Mount the upper two Tie-Rods. If SmartRow is correctly in place, tighten all bolts firmly. If you are seated on your WaterRower the battery cable must be on the left side.

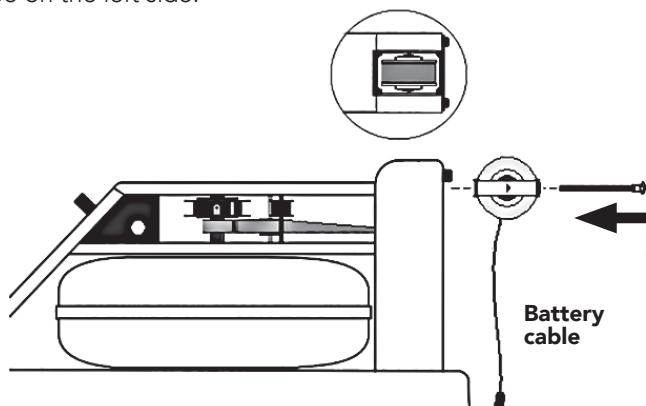

## Step 7

Hold the handle in the correct position (screws down) and feed the drive strap over the SmartRow. Pass the drive strap around the SmartRow and underneath the top-deck back towards the clutch housing.

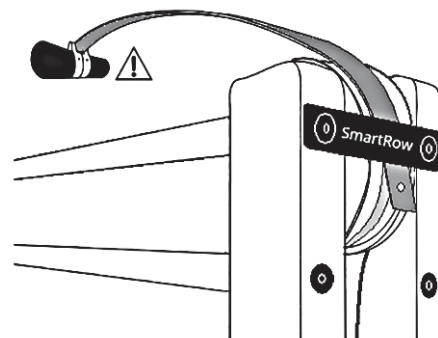

## Step 8

Slide the drive strap in the clutch and fix it using the 3 mm Allen key. Use drawing 8 and 9 to find the correct way.

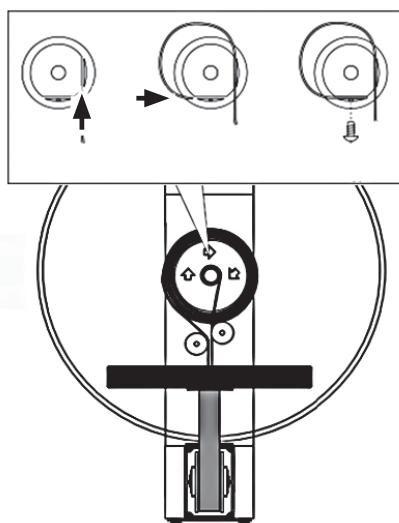

## Step 9

Carefully pull the recoil belt, causing the drive strap to wind itself around the clutch. When the handle arrives near the SmartRow pulley it is important that the recoil belt wraps 1 or 2 turns around the recoil bush before you go to the next step. Once this is done, feed the recoil belt over the two pulleys in the forward riser.

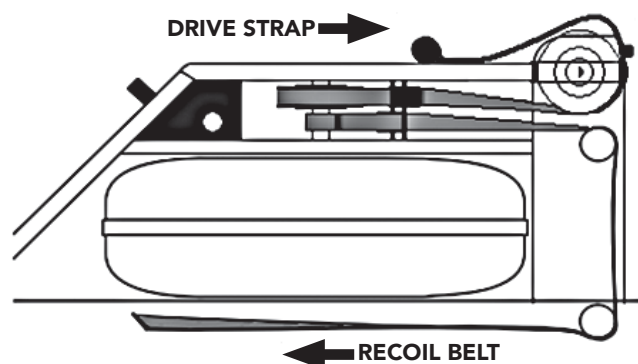

## Step 10

Stand the WaterRower upright and reconnect the bungee to the recoil belt. Use the double-sided foam tape to stick the battery pack to the metal bracket. Feed the battery-cable of the SmartRow downwards and connect the clip to the battery pack. Lay the WaterRower down and pull the handle once. You should see blue light coming out of the SmartRow indicating that it is trying to establish a Bluetooth connection. Open the 'SmartRow'-app (go to settings > SmartRow) to make a connection.

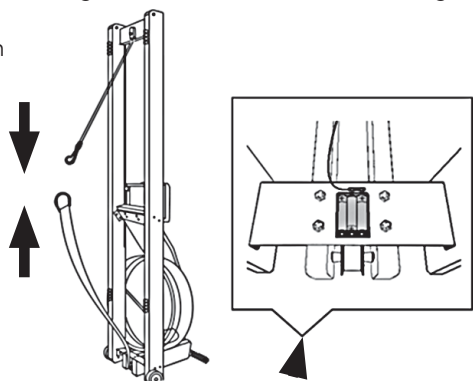

**SR**  
SmartRow